

KEY SWITCH AND  
COVER INCLUDED  
2X4X 2 1/2 BOX NOT INCLUDED

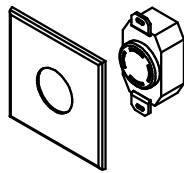

L14-20 RECEPT. AND  
COVER INCLUDED  
4X4 BOX NOT INCLUDED

HOIST COMPATIBLE WITH THE 4020 AND 4030 DIVIDER  
CURTAINS AND THE 4080 & 4080BL MULTISPORT CAGE.

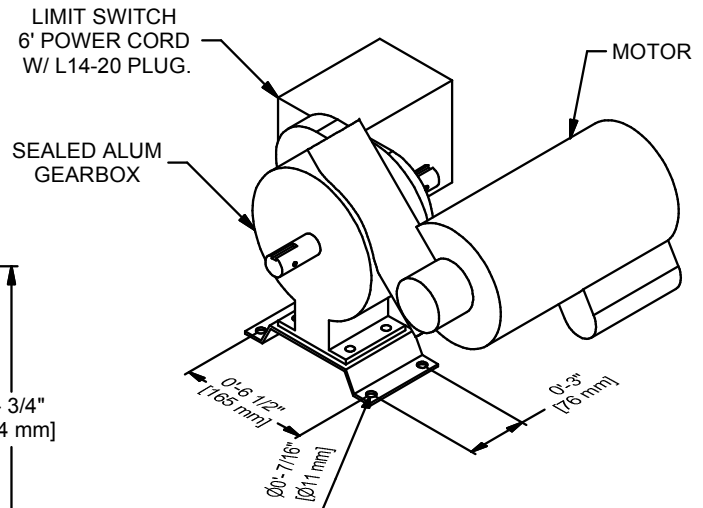
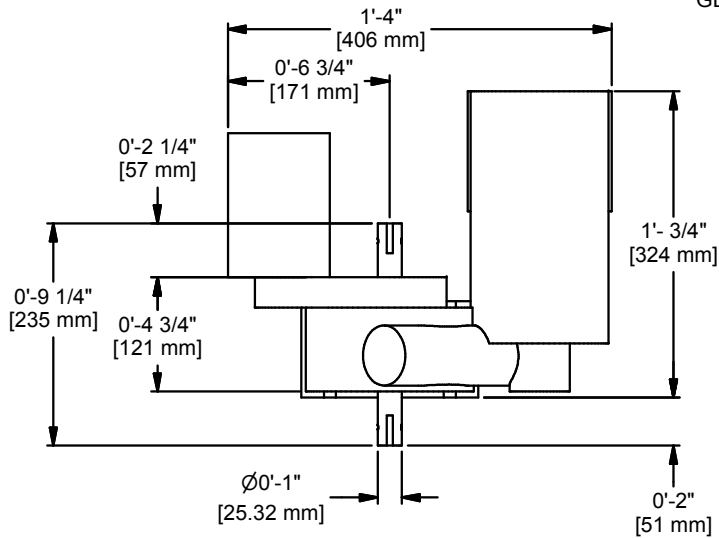

UNIT INCLUDES A 6' POWER CORD  
WITH A L14-20 PLUG AND  
A L14-20 RECEPTACLE.

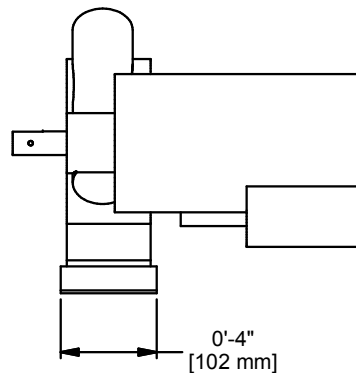
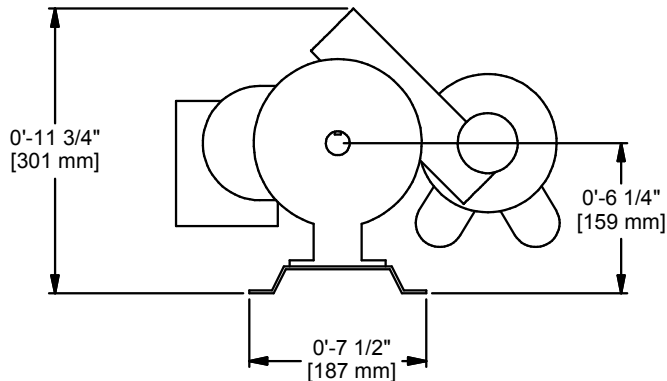

#### NOTES:

MOTOR DATA: 3/4 HP 110/115/120 VAC, 60 HZ, SINGLE PHASE,  
INSTANT REVERSE, THERMALLY PROTECTED.

HOIST MAY BE MOUNTED IN ANY DIRECTION.

#### CAUTION:

KEY SWITCH MUST BE LOCATED IN AN AREA  
THAT ALLOWS THE CURTAIN TO BE VISIBLE  
TO THE OPERATOR.

B	WDC	11-09-16
A	WDC	03-19-15
REV	BY	DATE



Gared Holdings, LLC  
9200 E. 146th St. Noblesville, IN 46060

THIS DOCUMENT CONTAINS TRADE SECRET AND OTHER MATERIALS  
WHICH ARE PROTECTED BY CONFIDENTIALITY NOTICE AND AGREEMENT  
AND BY COPYRIGHT. ANY USE OR COPYING OF THIS DOCUMENT EXCEPT  
AS AUTHORIZED BY GARED HOLDINGS, LLC IS STRICTLY PROHIBITED.

#### CURTAIN HOIST 3/4HP 115V, 1PH, 60HZ

DRAWN	CROSBY	DATE	3/19/2015	DATE ISSUED
APPROVED		DATE		
FILE LOC. Q:\Inventor Files\Specification Files\10_Curtains				
SIZE	SCALE	SHT. NO.	PART NO.	REV
A		1 OF 3	4002-R000	B



## MODEL 4002

### ELECTRIC CURTAIN HOIST

For use with 4020 & 4030 Divider Curtains or 4080 & 4080BL Multi-Sport Cage.

Electric hoist shall be equipped with a 3/4 horsepower, 115-volt AC, 60-hertz, single-phase, instant-reverse motor with thermal overload protection. The hoist has a 200:1 gear reduction. The double worm gear design holds the curtain in any position in the event of power failure. Gear box is filled with oil and completely sealed at the factory.

The electric hoist is operated from a three-position momentary contact switch which is included. Rotary counting limit switches control the raising and lowering of the curtain. Hoist shall be pre-wired and come complete with twist lock L14-20 plug and L14-20 receptacle. 4" receptacle box is not included.

Maximum Load	2,300 in-lbs torque.
Load Type	Vertical Lifting.
Speed	8.1 rpm
Electrical	110/115/120 VAC, 60 Cycle, 1 Phase.
Motor	3/4 HP, 10A (Full load amperage). Instant reversing, low maximum current draw design. UL, CSA listed.
Duty Cycle	Standard: 15 Minutes ON, 20 Minutes OFF.
Gear Reduction	200:1 double worm gearbox with hardened metal gears in a sealed aluminum gear case with precision ball bearings.
Drive	1" diameter double output shaft.
Limit Switches	Heavy duty upper and lower limit switches, gear driven for high accuracy. Maximum limit rotation is 50 turns.
Frame Construction	Precision machined aluminum gear case.
Weight	47 lbs.

**All conduits, wiring, junction boxes and other components not listed above shall be supplied by the electrical contractor.**

#### ACCESSORIES

Hoist can be used with wireless remote receiver 1199 or the TSC Total System Control. Wireless remote and TSC sold separately.

#### **WARNING:**

- Not to be used for lifting people.
- Not recommended for lifting objects over people without either a safety locking device or an automatic fall arrester system installed.

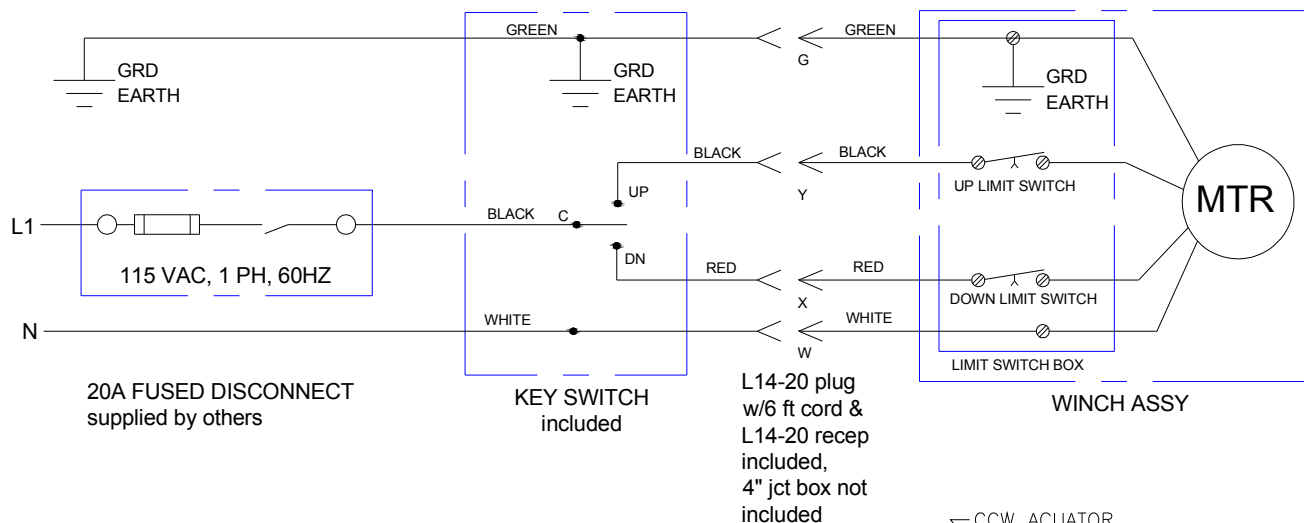

WIRING SUPPLIED BY OTHERS

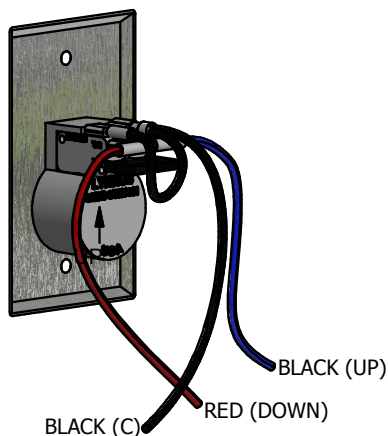
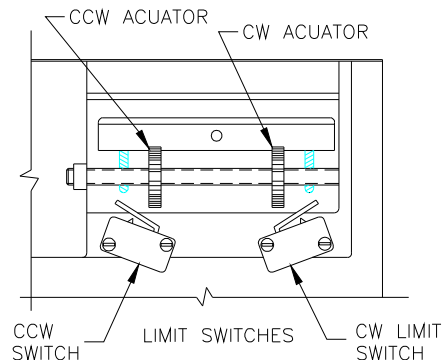

KEY SWITCH

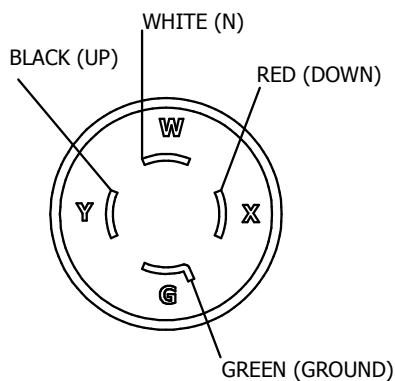

L14-20 RECEPTACLE

## ELECTRICAL REQUIREMENTS

**MINIMUM CIRCUIT REQUIREMENTS**  
-DEDICATED 115VAC, 1PH, 60HZ,  
20 AMP SERVICE

**MOTOR SPECIFICATION**  
-3/4HP 115V, 1PH, 60HZ, 9.5 FLA  
INSTANT REVERSING, THERMAL O/L

**MINIMUM WIRE SIZE**  
(copper wire, 3% max voltage drop)  
0-90 ft.....12 ga.  
90-140 ft.....10 ga.  
140-240 ft.....8 ga.  
240-380 ft..... 6 ga.

B	WDC	11-09-16
A	WDC	03-19-15
REV	BY	DATE



Gared Holdings, LLC  
9200 E. 146th St. Noblesville, IN 46060

THIS DOCUMENT CONTAINS TRADE SECRET AND OTHER MATERIALS WHICH ARE PROTECTED BY CONFIDENTIALITY NOTICE AND AGREEMENT AND BY COPYRIGHT. ANY USE OR COPYING OF THIS DOCUMENT EXCEPT AS AUTHORIZED BY GARED HOLDINGS, LLC IS STRICTLY PROHIBITED.

## CURTAIN HOIST 3/4HP 115V, 1PH, 60HZ

DRAWN	CROSBY	DATE	3/19/2015	DATE ISSUED
APPROVED		DATE		
FILE LOC. Q:\Inventor Files\Specification Files\10_Curtains				
SIZE	SCALE	SHT. NO.	PART NO.	REV
A		3 OF 3	4002-R000	B